

*UniQube  
Heart of your system*



# UniPlate

## Solar Collectors

# UniPlate

## Solar Collector

- Full plate high performance absorber
- High transmission tempered safety glass
- Optimal insulation
- Aluminium casing
- Easy to install
- 10 years guarantee
- Stability and reliability

UNIPLATE MODEL - SOLAR COLLECTOR		
TYPE		ESK 2.5 SB
Gross area / Light entering area	(m <sup>2</sup> )	2,49 / 2,35
Absorber surface (corrugate)	(m <sup>2</sup> )	2,32
Absorber material		copper sheet with "Eta plus" selective surface coating
Absorption coefficient (Eta plus)	(%)	95 ± 2
Emission coefficient (Eta plus)	(%)	5 ± 2
Cu Pipe register frame	(mm)	Φ 8 x 0,5
Collective Cu pipe frame	(mm)	Φ 22 x 0,8
Absorber volume	(l)	1,7
Transparent front cover		4mm tempered solar glass
Solar light transmission through glass	(%)	92 ± 2
Solar energy transmission through glass	(%)	91 ± 2
Number of connections		4
Connection diameter	(mm)	Φ 22
Max. working / test pressure	(bar)	10 / 14
Stagnation temperature	(°C)	199
Insulation - back side		40 mm glass wool (50kg/m <sup>3</sup> )
Insulation - on the sides		-
Back area		0.5 mm embossed alu sheet
Collector construction		alu profile AlMgSi 0,5 F22
Welding method		ultrasonic
Height/ Width/Depth	(mm)	2150 / 1160 / 90
Weight	(kg)	45

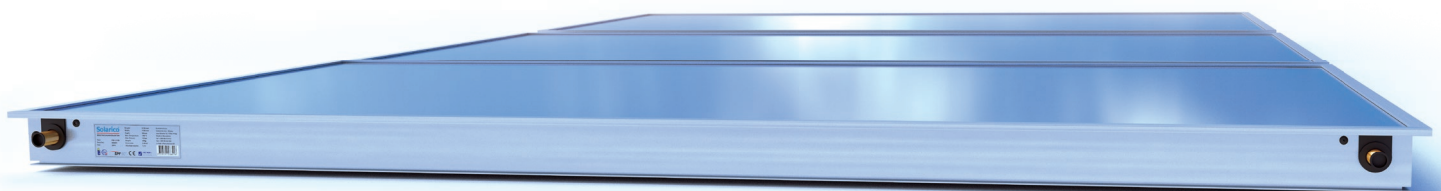

### UNIPLATE - MOUNTING SETS

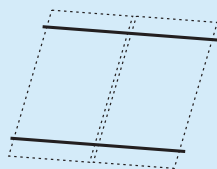

#### **Solarico parallel to roof mounting set for 2 UniPlate 2.5 SB vertical collectors**

Consisting of: 6 on-roof attachments for parallel mounting, C-profiles with fixing steel screws, nuts and flat washers; 4 pieces of anti-slip protection brackets, 2 collector attachment sets including its fixing steel screws, nuts and flat washers.

#### **Solarico connecting fitting set for 2 UniPlate 2.5 SB collectors**

Consisting of: 2 pieces of straight fitting  $\Phi 22$ , 4 pieces of straight male or female threads  $\Phi 22\text{mm}/3/4''$  and 2 pieces of female or male ending cap.

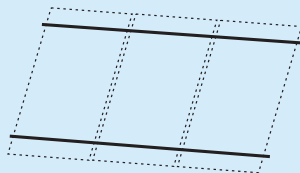

#### **Solarico parallel to roof mounting set for 3 UniPlate 2.5 SB vertical collectors**

Consisting of: 8 on-roof attachments for parallel mounting, C-profiles with fixing steel screws, nuts and flat washers; 6 pieces of anti-slip protection brackets, 3 collector attachment sets including its fixing steel screws, nuts and flat washers.

#### **Solarico connecting fitting set for 3 UniPlate 2.5 SB collectors**

Consisting of: 4 pieces of straight fitting  $\Phi 22$ , 4 pieces of straight male or female threads  $\Phi 22\text{mm}/3/4''$  and 2 pieces of female or male ending cap.

# UniPlate

## Accessories

### UNIPLATE - MOUNTING SETS

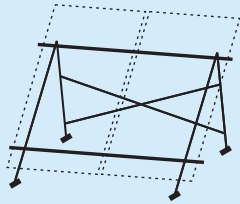

#### **Solarico flat roof mounting set for 2 UniPlate 2.5 SB vertical collectors**

Consisting of: Painted steel L-profiles, painted steel flat bars and galvanized steel C-profiles with fixing steel screws, nuts and flat washers; 4 pieces of anti-slip protection brackets, 2 collector attachment sets including its fixing steel screws, nuts and flat washers.

#### **Solarico connecting fitting set for 2 UniPlate 2.5 SB collectors**

Consisting of: 2 pieces of straight fitting  $\Phi 22$ , 4 pieces of straight male or female threads  $\Phi 22\text{mm}/3/4''$  and 2 pieces of female or male ending cap.

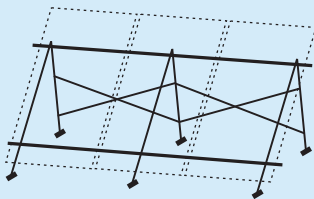

#### **Solarico flat roof mounting set for 3 UniPlate 2.5 SB vertical collectors**

Consisting of: Painted steel L-profiles, painted steel flat bars and galvanized steel C-profiles with fixing steel screws, nuts and flat washers; 6 pieces of anti-slip protection brackets, 3 collector attachment sets including its fixing steel screws, nuts and flat washers.

#### **Solarico connecting fitting set for 2 UniPlate collectors**

Consisting of: 4 pieces of straight fitting  $\Phi 22$ , 4 pieces of straight male or female threads  $\Phi 22\text{mm}/3/4''$  and 2 pieces of female or male ending cap.

# UniPlate

## Accessories

UNIPLATE - CONNECTORS	
1	Straight fitting-male thread $\Phi 22$ mm - 3/4"
2	Female cap - 3/4"
3	Straight fitting $\Phi 22$ mm
4	Compensation joint $\Phi 22$ mm

UNIPLATE - SPARE PARTS	
5	Side bracket set for 1 collector (4 brackets, 4 bolts with nuts)
6	Anti slip protection
7	Coupling for the profile (bracket, 4 bolts with nuts)
8	On-roof attachment for parallel mounting
9	C-profile

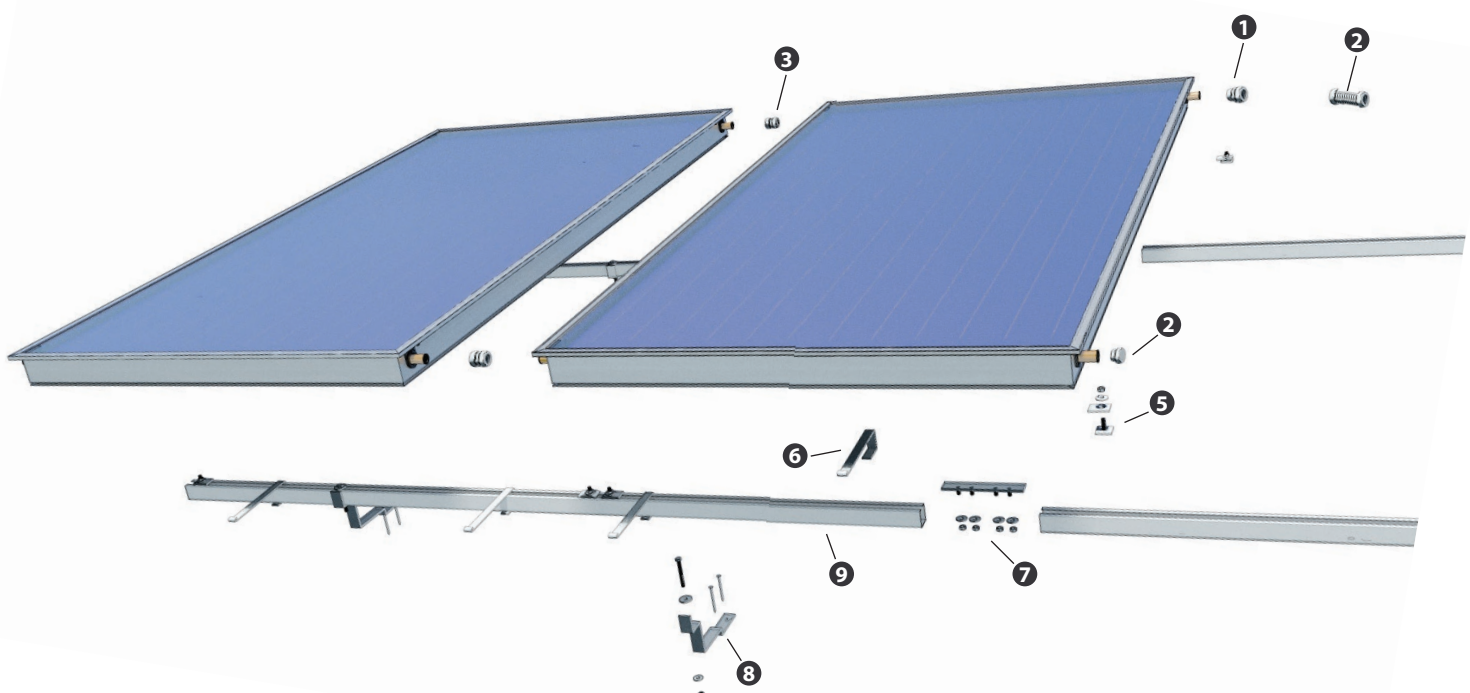

# UniPlate

## Solar Collector

Model		ESK 2.5 SB	ESK 2.3 SB	ESK 2.1 SB	ESK 2.5 SB - U	ESK 2.3 SB - U	ESK 2.1 SB - U
Gross area / Light entering area	(m <sup>2</sup> )	2,49 / 2,35	2,3 / 2,15	2,1 / 1,95	2,49 / 2,35	2,3 / 2,15	2,1 / 1,95
Absorber surface (corrugate)	(m <sup>2</sup> )	2,32	2,12	1,92	2,32	2,12	1,92
Absorber material		copper sheet with "Eta plus" selective surface coating			copper sheet with "Eta plus" selective surface coating		
Absorption coefficient (Eta plus)	(%)	95 ± 2	95 ± 2	95 ± 2	95 ± 2	95 ± 2	95 ± 2
Emission coefficient (Eta plus)	(%)	5 ± 2	5 ± 2	5 ± 2	5 ± 2	5 ± 2	5 ± 2
Cu Pipe register frame	(mm)	Φ 8 x 0,5	Φ 8 x 0,5	Φ 8 x 0,5	Φ 8 x 0,5	Φ 8 x 0,5	Φ 8 x 0,5
Collective Cu pipe frame	(mm)	Φ 22 x 0,8	Φ 22 x 0,8	Φ 22 x 0,8	Φ 22 x 0,8	Φ 22 x 0,8	Φ 22 x 0,8
Absorber volume	(l)	1,7	1,5	1,3	1,7	1,5	1,3
Transparent front cover		4mm tempered solar glass			4mm tempered solar glass		
Solar light transmission through glass	(%)	92 ± 2	92 ± 2	92 ± 2	92 ± 2	92 ± 2	92 ± 2
Solar energy transmission through glass	(%)	91 ± 2	91 ± 2	91 ± 2	91 ± 2	91 ± 2	91 ± 2
Number of connections		4	4	4	2	2	2
Connection diameter	(mm)	Φ 22	Φ 22	Φ 22	Φ 22	Φ 22	Φ 22
Max. working / test pressure	(bar)	10 / 14			10 / 14		
Stagnation temperature	(°C)	199			199		
Insulation - back side		40 mm glass wool (50kg/m <sup>3</sup> )			40 mm glass wool (50kg/m <sup>3</sup> )		
Insulation - on the sides		-			-		
Back area		0.5 mm embossed aluminium sheet			0.5 mm embossed aluminium sheet		
Collector construction		aluminium profile AlMgSi 0,5 F22			aluminium profile AlMgSi 0,5 F22		
Welding method		ultrasonic			ultrasonic		
Height/ Width/Depth	(mm)	2150 / 1160 / 90	2150 / 1068 / 90	2150 / 976 / 90	2150 / 1160 / 90	2150 / 1068 / 90	2150 / 976 / 90
Weight	(kg)	45	41	37	45	41	37
Absorber type		